

4. Follow the child seat maker's instructions for any additional advice on adjusting or tightening the fit.

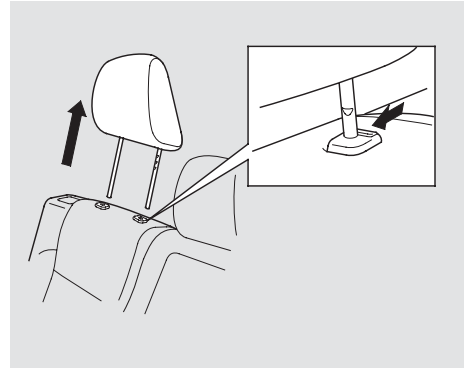

5. Remove the head restraint (see page 99 ).

Make sure the removed head restraints are secured in the cargo area. Reinstall the head restraints when the child seat is removed.

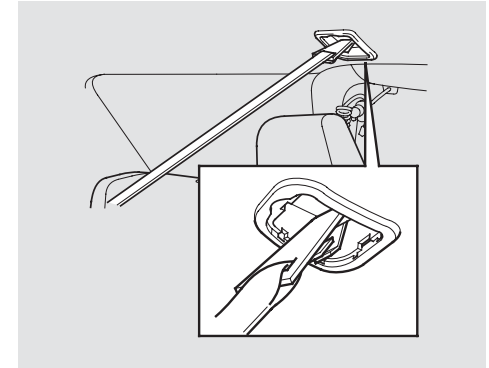

6. Attach the tether strap hook to the tether anchorage point and tighten the strap according to the child seat maker's instructions. Make sure the strap is not twisted.
7. Push and pull the child seat forward and from side to side to verify that it is secure enough to stay upright during normal driving maneuvers.